**APPLICATION:**

A SPRINKLER HANGER recommended to provide vertical support to non insulated piping systems. By adjusting the position of the sprinkler nut on the hanger rod at the top of the hanger, pipe elevation can be altered.

CONSTRUCTION:

A SPRINKLER HANGER consists of a piece of mild steel shaped to support pipe. Gives Double thickness at the support. Most suitable for fire extinguishing pipes installation.

MATERIAL:

Mild Steel. Also other materials can be provided on request

APPROVALS:

ANSI/MSS SP-58 & SP-69(Type 10) **MSS**
Federal Specification WW-H-171E & A-A-1192A(Type 10)

MAXIMUM TEMPERATURE: 343°C(650°F)

FINISH AVAILABLE:

Plain, Electro-Galvanized, Hot Dip Galvanized, Zinc Flake & Epoxy Coated.

PRODUCT CODE	NOMINAL IN.	PIPE SIZE MM	PIPE OD (MM) D	HEIGHT H	HANGER ROD SIZE (MM) R	MAX LOAD (KG)
TGSHNOUFE0027	3/4"	DN20	26.7	61	M10	220
TGSHNOUFE0034	1"	DN25	33.4	70	M10	220
TGSHNOUFE0042	1 1/4"	DN32	42.1	78	M10	220
TGSHNOUFE0048	1 1/2"	DN40	48.2	84	M10	220
TGSHNOUFE0060	2"	DN50	60.3	102	M10	220
TGSHNOUFE0073	2 1/2"	DN65	73.0	118	M10	300
TGSHNOUFE0089	3"	DN80	88.9	144	M10	300
TGSHNOUFE0114	4"	DN100	114.3	176	M10	300
TGSHNOUFE0168	6"	DN150	168.3	262	M12	550
TGSHNOUFE0219	8"	DN200	219.1	305	M12	1300

APPLICATION EXAMPLES:

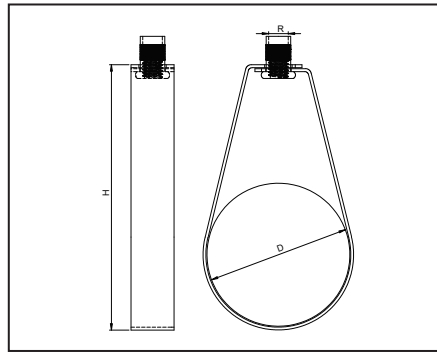
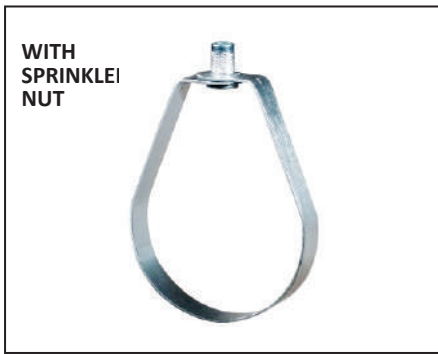
**APPLICATION:**

A SPRINKLER HANGER recommended to provide vertical support to non insulated piping systems. By adjusting the position of the sprinkler nut on the hanger rod at the top of the hanger, pipe elevation can be altered.

CONSTRUCTION:

A SPRINKLER HANGER consists of a piece of mild steel shaped to support pipe. Gives Double thickness at the support. Most suitable for fire extinguishing pipes installation.

MATERIAL:

Mild Steel. Also other materials can be provided on request

APPROVALS:

ANSI/MSS SP-58 & SP-69(Type 10) 
Federal Specification WW-H-171E & A-A-1192A(Type 10)

MAXIMUM TEMPERATURE: 343°C(650°F)

FINISH AVAILABLE:

Plain, Electro-Galvanized, Hot Dip Galvanized, Zinc Flake & Epoxy Coated.

PRODUCT CODE	NOMINAL IN.	PIPE SIZE MM	PIPE OD (MM) D	HEIGHT (MM) H	HANGER ROD SIZE (MM) R	MAX LOAD (KG)
TGSHN000E0027	3/4"	DN20	26.7	61	M10	220
TGSHN000E0034	1"	DN25	33.4	70	M10	220
TGSHN000E0042	1 1/4"	DN32	42.1	78	M10	220
TGSHN000E0048	1 1/2"	DN40	48.2	84	M10	220
TGSHN000E0060	2"	DN50	60.3	102	M10	220
TGSHN000E0073	2 1/2"	DN65	73.0	118	M10	300
TGSHN000E0089	3"	DN80	88.9	144	M10	300
TGSHN000E0114	4"	DN100	114.3	176	M10	300
TGSHN000E0168	6"	DN150	168.3	262	M12	550
TGSHN000E0219	8"	DN200	219.1	305	M12	1300

APPLICATION EXAMPLES:

**APPLICATION:**

A SPRINKLER HANGER recommended to provide vertical support to non insulated piping systems. By adjusting the position of the sprinkler nut on the hanger rod at the top of the hanger, pipe elevation can be altered.

CONSTRUCTION:

A SPRINKLER HANGER consists of a piece of mild steel shaped to support pipe. Gives Double thickness at the support. Most suitable for fire extinguishing pipes installation.

MATERIAL:

Mild Steel. Also other materials can be provided on request

APPROVALS:

ANSI/MSS SP-58 & SP-69(Type 10) 
Federal Specification WW-H-171E & A-A-1192A(Type 10)

MAXIMUM TEMPERATURE: 343°C(650°F)

FINISH AVAILABLE:

Plain, Electro-Galvanized, Hot Dip Galvanized, Zinc Flake & Epoxy Coated.

PRODUCT CODE	NOMINAL IN.	PIPE SIZE MM	PIPE OD (MM) D	HEIGHT H	HANGER ROD SIZE (MM) R	MAX LOAD (KG)
TGSH0000E0027	3/4"	DN20	26.7	61	M10	220
TGSH0000E0034	1"	DN25	33.4	70	M10	220
TGSH0000E0042	1 1/4"	DN32	42.1	78	M10	220
TGSH0000E0048	1 1/2"	DN40	48.2	84	M10	220
TGSH0000E0060	2"	DN50	60.3	102	M10	220
TGSH0000E0073	2 1/2"	DN65	73.0	118	M10	300
TGSH0000E0089	3"	DN80	88.9	144	M10	300
TGSH0000E0114	4"	DN100	114.3	176	M10	300
TGSH0000E0168	6"	DN150	168.3	262	M12	550
TGSH0000E0219	8"	DN200	219.1	305	M12	1300

APPLICATION EXAMPLES: