**APPLICATION:**

SPRING HANGERS are used to isolate suspended sources of both noise and vibration. Suspended mechanical equipment such as air handling units, FCU's cabinet fans, piping and ductwork in close proximity to rotating mechanical equipment are typical applications of model hangers.

**FEATURES:**

SPRING HANGERS consist of freestanding; laterally stable steel springs in series with a moulded elastomeric element assemble into a stamped and welded hanger bracket. The hanger brackets and the springs are powder coated. Spring Vibration isolation hangers are designed to provide high efficiency isolation from structure-borne vibration and noise. Springs are colour-coded according to load ratings and are designed for 50% overload.

PRODUCT CODE	COLOUR CODE	RATED LOAD (KG)	DEFLECTION (MM)	M (MM)	L (MM)	W (MM)	H (MM)	F (MM)	TOP HOLE (MM)
TGSPH02500010	PURPLE	10	25	53	62	52	100	12	13
TGSPH02500015	YELLOW	15	25	53	62	52	100	12	13
TGSPH02500020	GREY	20	25	53	62	52	100	12	13
TGSPH02500040	LIGHT BLUE	40	25	53	62	52	100	12	13
TGSPH02500060	GREEN	60	25	53	62	52	100	12	13
TGSPH02500100	GREEN	100	25	83	90	65	125	14	15
TGSPH02500160	ORANGE	160	25	83	90	65	125	14	15
TGSPH02500200	RED	200	25	83	90	65	125	14	15
TGSPH02500250	PURPLE	250	25	83	90	65	125	14	15
TGSPH02500300	GREY	300	25	102	112	95	165	18	19
TGSPH02500400	ORANGE	400	25	102	112	95	165	18	19
TGSPH02500500	BROWN	500	25	102	112	95	165	18	19
TGSPH02500600	BLACK	600	25	102	112	95	165	18	19
TGSPH02500800	RED	800	25	102	112	95	165	18	19
TGSPH02501050	WHITE	1050	25	102	112	95	165	18	19
TGSPH02501250	GREEN	1250	25	102	112	95	165	18	19

Due to policy of continual improvement, the specifications are subject to change without prior notice.

Measurements are subject to 5% tolerance.

To achieve good sound suppressions do not over load fitting.

Compliance – Springs designed according to BS 1726 (Part 1) : 1987 and recommendations made by SAE (US)

**APPLICATION EXAMPLES:**

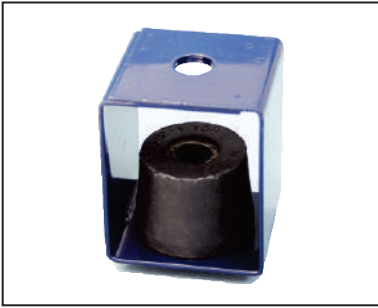

PRODUCT CODE	POINT LOAD KGS	DEFLECTION MM	ROD SIZE MM
TGRH000000010	10	8	10
TGRH000000020	20	8	10
TGRH000000030	30	8	10
TGRH000000050	50	8	10
TGRH000000070	70	10	10
TGRH000000120	120	10	10

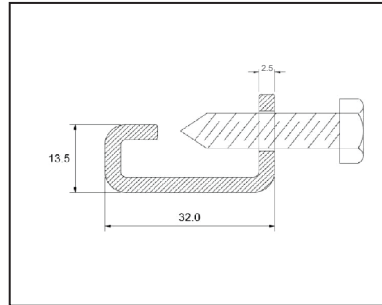

**BOLT:** M10 X 25 MM

**MATERIAL:** Mild Steel

**THICKNESS:** 2.5 MM

**FINISH:** Electro-Galvanized

**DIMENSIONS:** Mention in above drawing

#### APPLICATION EXAMPLES:





#### TYPICAL APPLICATIONS

- Duct Mount consist of a resilient rubber mount held between two plated steel caps
- For uniform distribution of load.If has an integral extended rubber sleeve which prevents direct metal-to-metal contact,thereby minimising transmission of noise and vibration.

#### SUSPENSION OF

- Fan Coil Units
- Pipes
- Ducts
- Brackets
- Light Weight Equipment

#### FLOOR MOUNTING OF

(using rubber element only)

- Refrigerators
- Domestic Appliances
- Industrial Equipments

PRODUCT CODE	POINT LOAD KGS	DEFLECTION MM	ROD SIZE MM
TGDM0S0000050	50	4	10
TGDM0B0000100	100	4	10

#### APPLICATION EXAMPLES:

